



# TECHNICAL UNIVERSITY OF MOMBASA

---

Faculty of Engineering and Technology

Department of Electrical and Electronic Engineering

## UNIVERSITY EXAMINATION FOR:

SUPPLEMENTARY EXAMINATION

Higher Diploma in Electrical Engineering

EEE 3106: COMPUTER AIDED DESIGN II

## END OF SEMESTER EXAMINATION

**SERIES:** DEC 2017

**TIME:** 2 HOURS

**DATE:** DEC 2017

### Instructions to Candidates

You should have the following for this examination

*-Answer Booklet, examination pass and student ID*

This paper consists of **five** Questions; Question ONE of section A is compulsory. In addition attempt any Other TWO Questions one from each section B and C.

**Do not write on the question paper.**

### SECTION A. This section is COMPULSORY

#### QUESTION ONE.

(a) Explain the following terms as used in AutoCAD

- i. Associated dimension
- ii. Orthogonal
- iii. baseline
- iv. dimension line arc

(8 marks)

(b) Explain the following commands in AutoCAD

- I. MIRROR
- II. DIVIDE
- III. LIMIT
- IV. DIMSTYLE

(8 marks)

(c) Explain how to draw a circle of diameter 40mm

(4 marks)

**SECTION B. Answer ONE question from this section.**

**QUESTION TWO.**

For the circuit of Figure Q2 reproduce the circuit in 2D using AutoCAD. (20 marks)

**QUESTION THREE.**

Using AutoCAD draw the THREE orthographic views in third angle projection of the block of figure Q3. (20 marks)

**SECTION C. Answer ONE question from this section.**

**QUESTION FOUR**

Using AutoCAD draw the 3D shape of Figure Q4. (20 marks)

**QUESTION FIVE**

Study the orthographic vies of figure Q5 and draw the locking block of Figure Q5 in isometric. Make point A the lowest point (20 marks)

FIGURE Q2

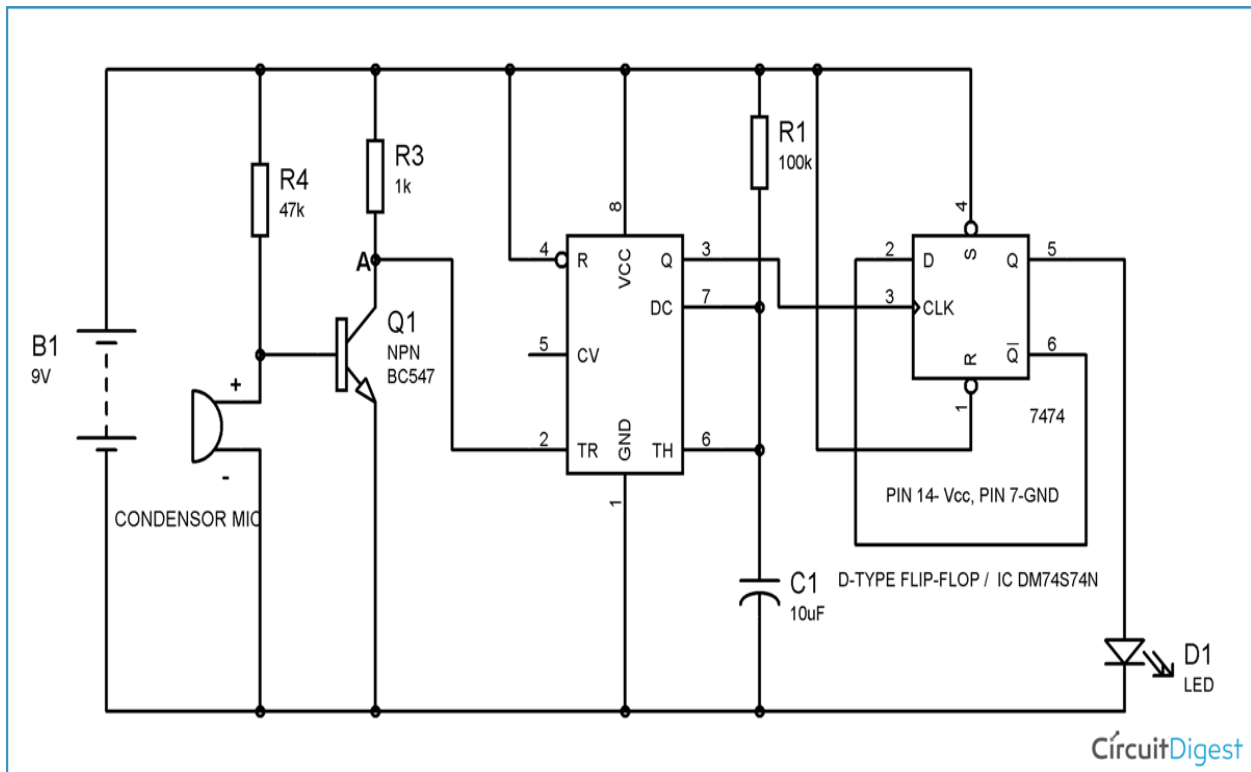

FIGURE Q3

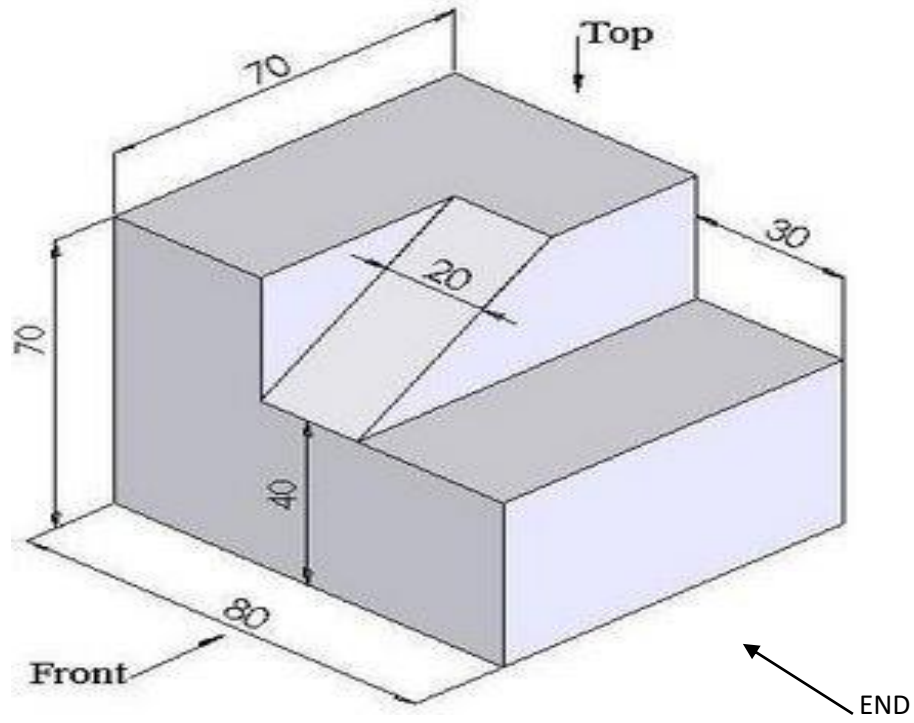

FIGURE Q4

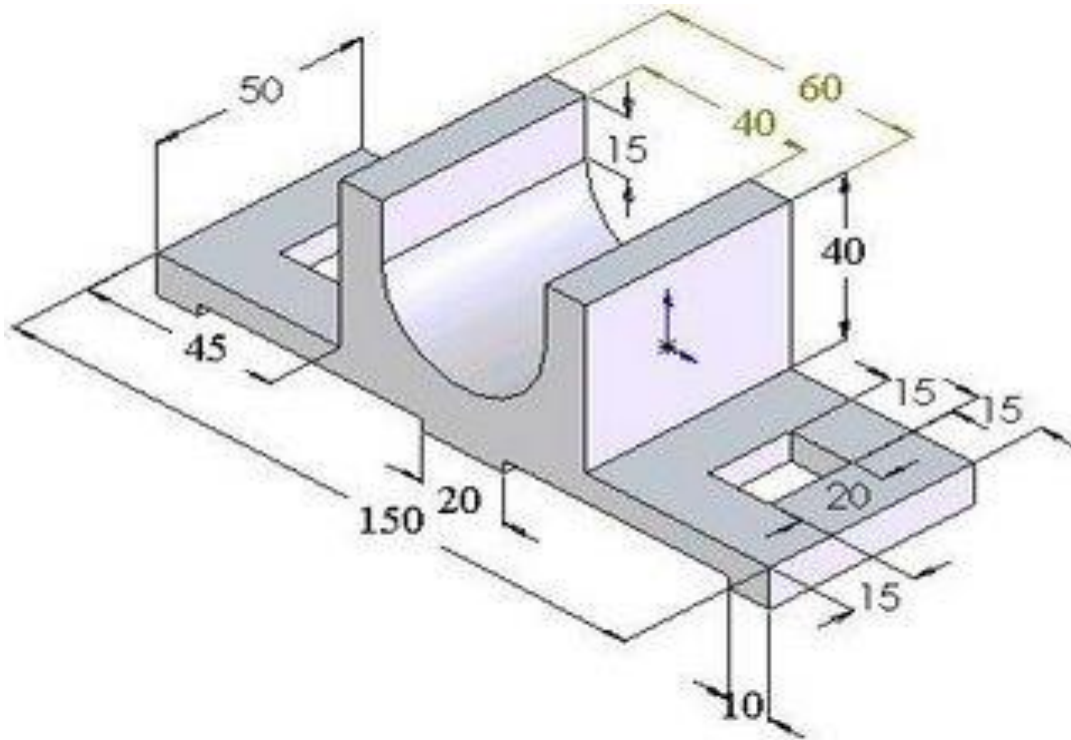
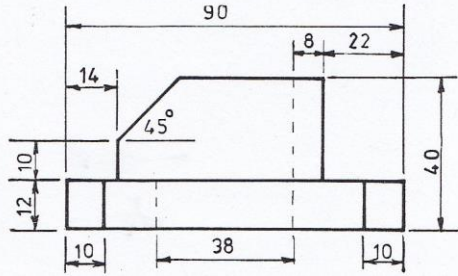
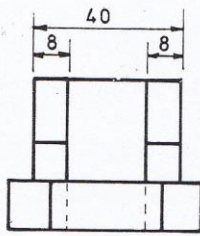
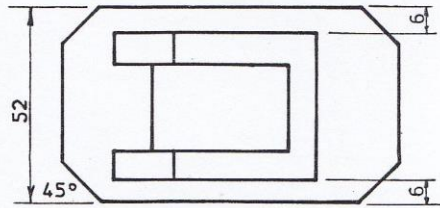
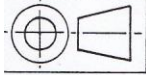

FIGURE Q5

N° 6

# LOCKING BLOCK



A

